

# Future Light

Soluções em Iluminação LED

**LINHA PERFL - 2023**

---



## LINHA PERFIL

TECNOLOGIA QUE TRANSFORMA

Iluminação para diferentes aplicações, versáteis e de fácil instalação, possui grande variedade de cores e uma luz homogênea. Permitem a personalização de ambientes e a liberdade na construção de efeito luminoso.



## Base No Frame



- 1 metro - Branco | FL1998
- 2 metros - Branco | FL1999
- 3 metros - Branco | FL2000
- 1 metro - Branco | FL2001
- 2 metros - Branco | FL2002
- 3 metros - Branco | FL2003

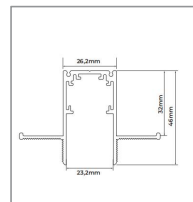

Perfil sem LED.

## Base Sobrepor



- 1 metro - Branco | FL2115
- 2 metros - Branco | FL2116
- 3 metros - Branco | FL2117
- 1 metro - Branco | FL2118
- 2 metros - Branco | FL2119
- 3 metros - Branco | FL2120

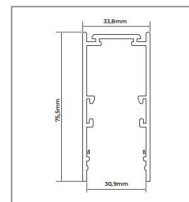

Perfil sem LED.

## Base Embutir



- 1 metro - Branco | FL2109
- 2 metros - Branco | FL2110
- 3 metros - Branco | FL2111
- 1 metro - Branco | FL2112
- 2 metros - Branco | FL2113
- 3 metros - Branco | FL2114

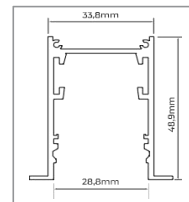

Perfil sem LED.

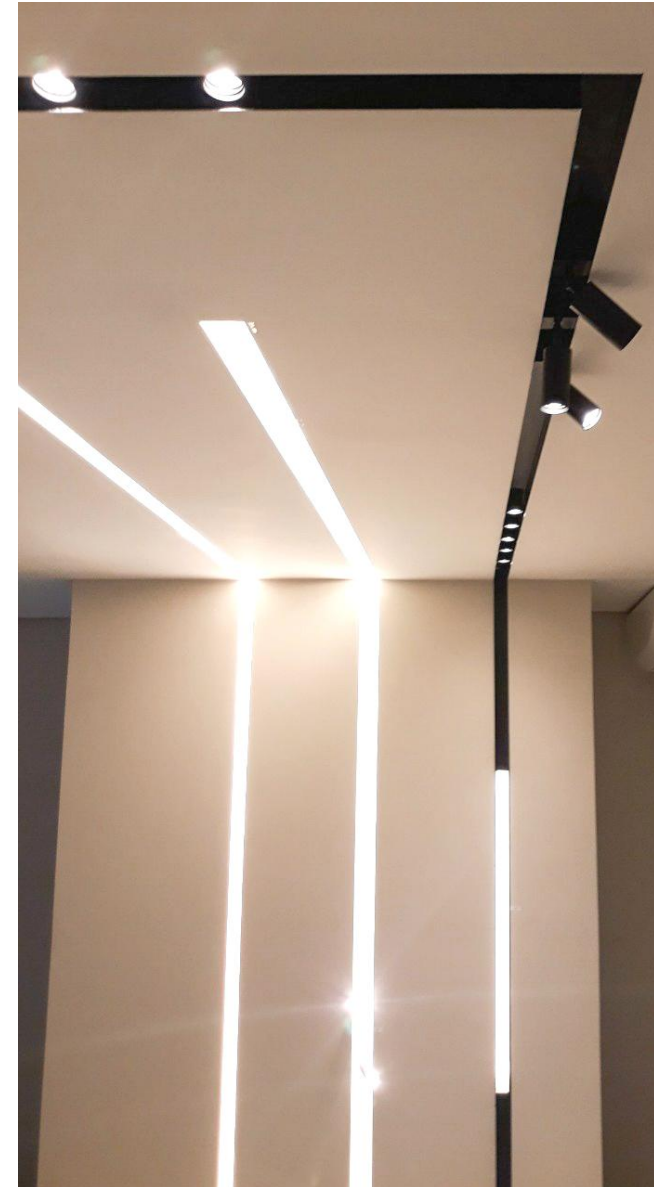

## Módulo Concentrado



- 1x | 12° | 2700k | FL2166
- 1x | 12° | 4000k | FL2167
- 3x | 12° | 2700k | FL2168
- 3x | 12° | 4000k | FL2169
- 5x | 12° | 2700k | FL2020
- 5x | 12° | 4000k | FL2021

## Módulo Difuso



- Branco 13,2cm | FL2126
- Preto 13,2cm | FL2108
- Preto/ Branco 13,2cm | FL2107

Perfil sem LED.

## Módulo Tampa cega



- 50 cm - Branco | FL2004
- 1 metro - Branco | FL2005
- 2 metros - Branco | FL2006
- 50 cm - Preto | FL2007
- 1 metro - Preto | FL2008
- 2 metros - Preto | FL2009

Perfil sem LED.





## Módulo Spot GU10 13,2cm

- Preto | FL2010
- Branco | FL2011
- Branco/ Dourado | FL2193
- Preto/ Dourado | FL2194
- Branco/ Cobre | FL2195
- Preto/ Cobre | FL2196
- Branco/ Rosê | FL2197
- Preto/ Rosê | FL2198

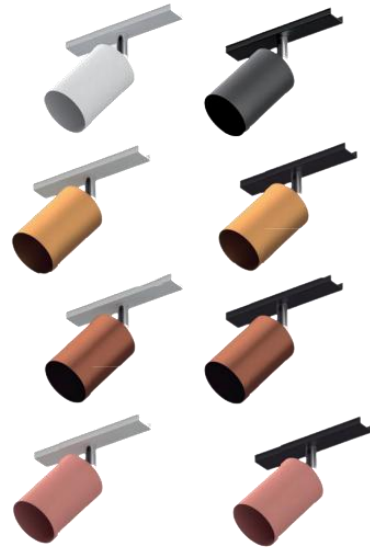

Lâmpada não inclusa  
Potência máxima suportada: Dicroica 8W

## Módulo Spot PAR20 13,2cm

- Preto | FL2012
- Branco | FL2013



Lâmpada não inclusa  
Potência máxima suportada: PAR20 8W

## Módulo Spot PAR30 13,2cm

- Preto | FL2016
- Branco | FL2017



Lâmpada não inclusa  
Potência máxima suportada: PAR30 8W

## Módulo Spot AR70 13,2cm

- Preto | FL2014
- Branco | FL2015



Lâmpada não inclusa  
Potência máxima suportada: AR70 8W

## Módulo Spot AR111 13,2cm

- Preto | FL2018
- Branco | FL2019



Lâmpada não inclusa  
Potência máxima suportada: AR111 15W



## Base

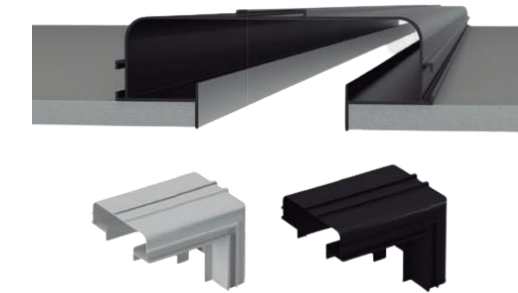

- 1 metro - Branco | FL2170
- 2 metros - Branco | FL2171
- 3 metros Branco | FL2172
- 1 metro Preto | FL2173
- 2 metros Preto | FL2174
- 3 metros Preto | FL2175
- Teto/ Parede Preto | FL2176
- Teto/Parede Branco | FL2177

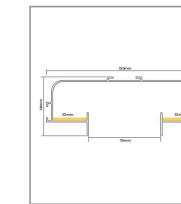

Perfil sem LED.

## Módulo Spot



- Branco | FL2178
- Preto | FL2179
- Dourado | FL2191

(Lâmpada não inclusa)  
Potência máxima suportada: Dicroica 8W - PAR20 8W - AR70 8W - PAR30 8W - AR111 até 15W

## Módulo Spot



- Branco | FL2181
- Preto | FL2180
- Dourado | FL2192

(Lâmpada não inclusa)  
Potência máxima suportada: Dicroica 8W - PAR20 8W - AR70 8W - PAR30 8W - AR111 até 15W

# NOFRAME WIDE

# DOT-LIGHT



## Módulo Concentrado



1x | 12" | 2700k - 3w | FL2184

1x | 12" | 4000k - 3w | FL2185

3x | 12" | 2700k - 5w | FL2182

3x | 12" | 4000k - 5w | FL2183

## Módulo Difuso



13,2cm | FL2186



## 1 Concentrado 2w



2700k | Branco/ Preto | FL2156

2700k | Preto/ Preto | FL2161

## 3 Concentrados 6w



2700k | Branco/ Preto | FL2157

2700k | Preto/ Preto | FL2162

## 5 Concentrados 10w



2700k | Branco/ Preto | FL2158

2700k | Preto/ Preto | FL2163

## 10 Concentrados 20w



2700k | Branco/ Preto | FL2159

2700k | Preto/ Preto | FL2164

## 15 Concentrados 30w

2700k | Branco/ Preto | FL2160

2700k | Preto/ Preto | FL2165



# PERFIS EMBUTIR LED INTEGRADO



## PERFIL FINO

15W



- 2700k | FL1655 ○
- 4000k | FL1656 ○
- 6000k | FL1657 ○
- 2700k | FL1664 ●
- 4000k | FL1665 ●
- 6000k | FL1666 ●

1 metro

Potência: 15w  
 Grau de proteção: IP20  
 Perfil: Branco/ Preto  
 Difusor: Leitoso  
 Dimensões: 1000x24x19mm

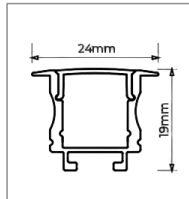

## PERFIL FINO

30W



- 2700k | FL1658 ○
- 4000k | FL1659 ○
- 6000k | FL1660 ○
- 2700k | FL1667 ●
- 4000k | FL1668 ●
- 6000k | FL1669 ●

2 metros

Potência: 30w  
 Grau de proteção: IP20  
 Perfil: Branco/ Preto  
 Difusor: Leitoso  
 Dimensões: 2000x24x19mm

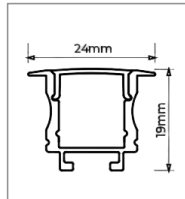

## PERFIL FINO

45W



- 2700k | FL1661 ○
- 4000k | FL1662 ○
- 6000k | FL1663 ○
- 2700k | FL1670 ●
- 4000k | FL1671 ●
- 6000k | FL1672 ●

3 metros

Potência: 45w  
 Grau de proteção: IP20  
 Perfil: Branco/ Preto  
 Difusor: Leitoso  
 Dimensões: 3000x24x19mm

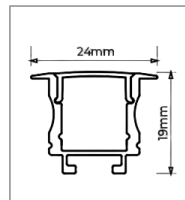

## PERFIL FINO

15W



- 2700k | FL1673 ○
- 4000k | FL1674 ○
- 6000k | FL1675 ○

1 metro

Potência: 15w  
 Grau de proteção: IP20  
 Perfil: Preto  
 Difusor: Fumê  
 Dimensões: 1000x24x19mm

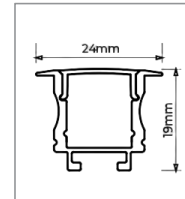

## PERFIL FINO

30W



- 2700k | FL1676 ○
- 4000k | FL1677 ○
- 6000k | FL1678 ○

2 metros

Potência: 30w  
 Grau de proteção: IP20  
 Perfil: Preto  
 Difusor: Fumê  
 Dimensões: 2000x24x19mm

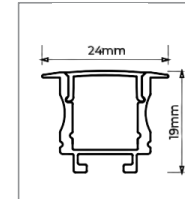

## PERFIL FINO

45W



- 2700k | FL1679 ○
- 4000k | FL1680 ○
- 6000k | FL1681 ○

3 metros

Potência: 45w  
 Grau de proteção: IP20  
 Perfil: Preto  
 Difusor: Fumê  
 Dimensões: 3000x24x19mm

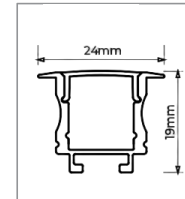





## CONECTOR PAREDE

3W



- 2700k | FL1682 ○
- 4000k | FL1683 ○
- 6000k | FL1684 ○
- 2700k | FL1685 ●
- 4000k | FL1686 ●
- 6000k | FL1687 ●

Potência: 3w  
 Grau de proteção: IP20  
 Perfil: Branco/ Preto  
 Difusor: Leitoso

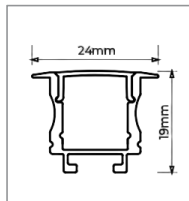

## CONECTOR TETO

3W



- 2700k | FL1700 ○
- 4000k | FL1701 ○
- 6000k | FL1702 ○
- 2700k | FL1703 ●
- 4000k | FL1704 ●
- 6000k | FL1705 ●

Potência: 3w  
 Grau de proteção: IP20  
 Perfil: Branco/ Preto  
 Difusor: Leitoso

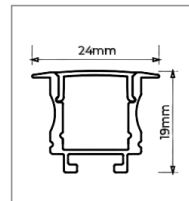

## CONECTOR POSITIVO

3W



- 2700k | FL1691 ○
- 4000k | FL1692 ○
- 6000k | FL1693 ○
- 2700k | FL1694 ●
- 4000k | FL1695 ●
- 6000k | FL1696 ●

Potência: 3w  
 Grau de proteção: IP20  
 Perfil: Branco/ Preto  
 Difusor: Leitoso

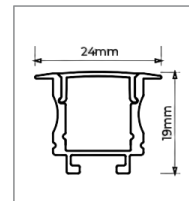

## CONECTOR PAREDE

3W

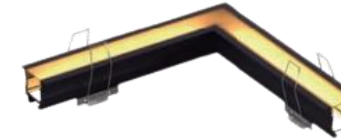

- 2700k | FL1688
- 4000k | FL1689
- 6000k | FL1690

Potência: 3w  
 Grau de proteção: IP20  
 Perfil: Preto  
 Difusor: Fumê

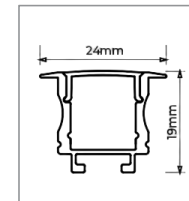

## CONECTOR TETO

3W



- 2700k | FL1706
- 4000k | FL1707
- 6000k | FL1708

Potência: 3w  
 Grau de proteção: IP20  
 Perfil: Preto  
 Difusor: Fumê

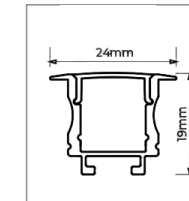

## CONECTOR POSITIVO

3W



- 2700k | FL1697
- 4000k | FL1698
- 6000k | FL1699

Potência: 3w  
 Grau de proteção: IP20  
 Perfil: Preto  
 Difusor: Fumê

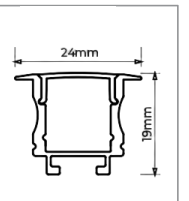



## PERFIL LARGO

15W

- 2700k | FL1709 ○
- 4000k | FL1710 ○
- 6000k | FL1711 ○
- 2700k | FL1718 ●
- 4000k | FL1719 ●
- 6000k | FL1720 ●

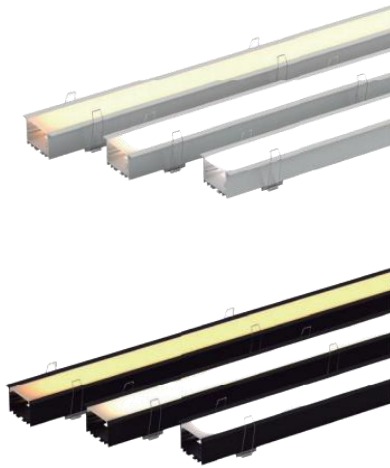

1 metro

- Potência: 15w
- Grau de proteção: IP20
- Perfil: Branco/ Preto
- Difusor: Leitoso
- Dimensões: 1000x46,6x25,8mm

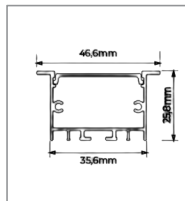

## PERFIL LARGO

30W

- 2700k | FL1712 ○
- 4000k | FL1713 ○
- 6000k | FL1714 ○
- 2700k | FL1721 ●
- 4000k | FL1722 ●
- 6000k | FL1723 ●

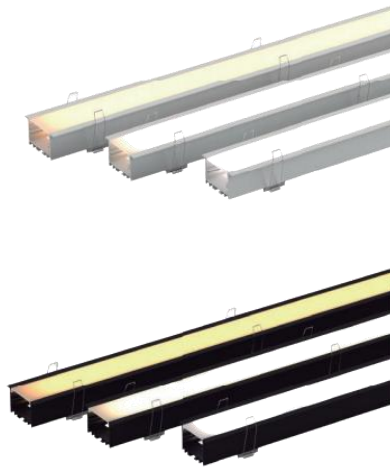

2 metros

- Potência: 30w
- Grau de proteção: IP20
- Perfil: Branco/ Preto
- Difusor: Leitoso
- Dimensões: 2000x46,6x25,8mm

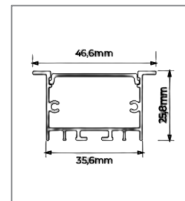

## PERFIL LARGO

45W

- 2700k | FL1715 ○
- 4000k | FL1716 ○
- 6000k | FL1717 ○
- 2700k | FL1724 ●
- 4000k | FL1725 ●
- 6000k | FL1726 ●

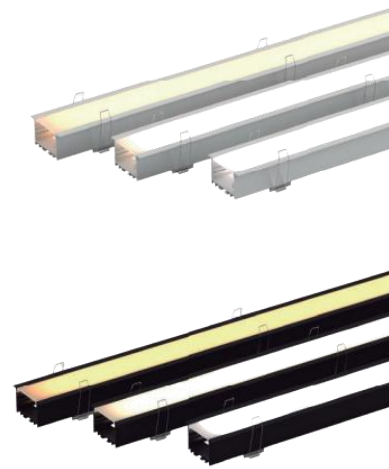

3 metros

- Potência: 45w
- Grau de proteção: IP20
- Perfil: Branco/ Preto
- Difusor: Leitoso
- Dimensões: 3000x46,6x25,8mm

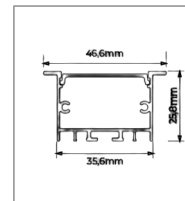

## PERFIL LARGO

15W

- 2700k | FL1727 ○
- 4000k | FL1728 ○
- 6000k | FL1729 ○



1 metro

- Potência: 15w
- Grau de proteção: IP20
- Perfil: Preto
- Difusor: Fumê
- Dimensões: 1000x46,6x25,8mm

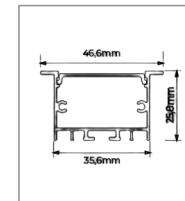

## PERFIL LARGO

30W

- 2700k | FL1730 ○
- 4000k | FL1731 ○
- 6000k | FL1732 ○



2 metros

- Potência: 30w
- Grau de proteção: IP20
- Perfil: Preto
- Difusor: Fumê
- Dimensões: 2000x46,6x25,8mm

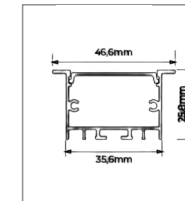

## PERFIL LARGO

45W

- 2700k | FL1733 ○
- 4000k | FL1734 ○
- 6000k | FL1735 ○



3 metros

- Potência: 45w
- Grau de proteção: IP20
- Perfil: Preto
- Difusor: Fumê
- Dimensões: 3000x46,6x25,8mm

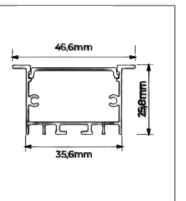





## CONECTOR PAREDE

3W

- 2700k | FL1736 ○
- 4000k | FL1737 ○
- 6000k | FL1738 ○
- 2700k | FL1739 ●
- 4000k | FL1740 ●
- 6000k | FL1741 ●



Potência: 3w  
 Grau de proteção: IP20  
 Perfil: Branco/ Preto  
 Difusor: Leitoso

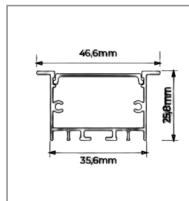

## CONECTOR TETO

3W

- 2700k | FL1755 ○
- 4000k | FL1756 ○
- 6000k | FL1757 ○
- 2700k | FL1758 ●
- 4000k | FL1759 ●
- 6000k | FL1760 ●

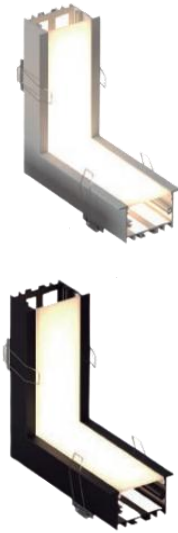

Potência: 3w  
 Grau de proteção: IP20  
 Perfil: Branco/ Preto  
 Difusor: Leitoso

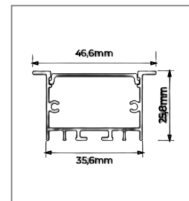

## CONECTOR POSITIVO

3W

- 2700k | FL1745 ○
- 4000k | FL1746 ○
- 6000k | FL1748 ○
- 2700k | FL1758 ●
- 4000k | FL1759 ●
- 6000k | FL1760 ●



Potência: 3w  
 Grau de proteção: IP20  
 Perfil: Branco/ Preto  
 Difusor: Leitoso

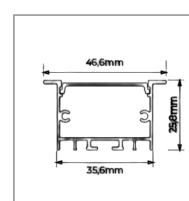

## CONECTOR PAREDE

3W

- 2700k | FL1742 ○
- 4000k | FL1743 ○
- 6000k | FL1744 ○

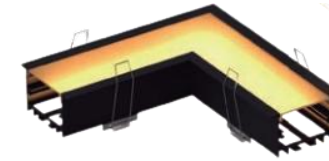

Potência: 3w  
 Grau de proteção: IP20  
 Perfil: Preto  
 Difusor: Fumê

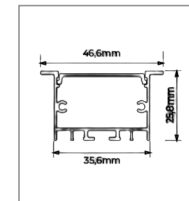

## CONECTOR TETO

3W

- 2700k | FL1761 ○
- 4000k | FL1762 ○
- 6000k | FL1763 ○



Potência: 3w  
 Grau de proteção: IP20  
 Perfil: Preto  
 Difusor: Fumê

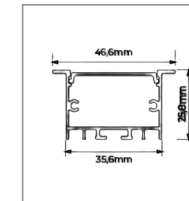

## CONECTOR POSITIVO

3W

- 2700k | FL1752 ○
- 4000k | FL1753 ○
- 6000k | FL1754 ○



Potência: 3w  
 Grau de proteção: IP20  
 Perfil: Preto  
 Difusor: Fumê

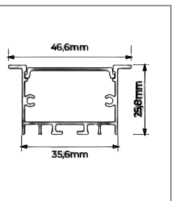



## PERFIL RECUADO

15W

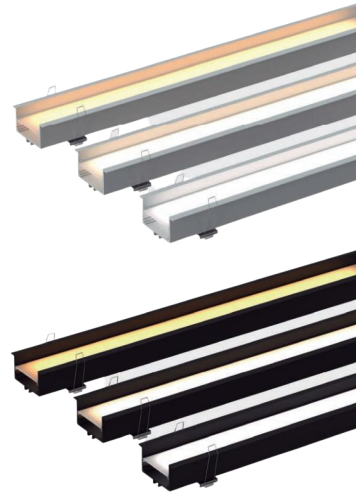

- 2700k | FL1764 ○
- 4000k | FL1765 ○
- 6000k | FL1766 ○
- 2700k | FL1773 ●
- 4000k | FL1774 ●
- 6000k | FL1775 ●

1 metro

Potência: 15w  
 Grau de proteção: IP20  
 Perfil: Branco/ Preto  
 Difusor: Leitoso  
 Dimensões: 1000x50x34mm

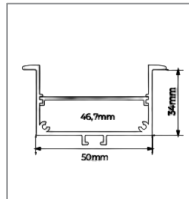

## PERFIL RECUADO

30W

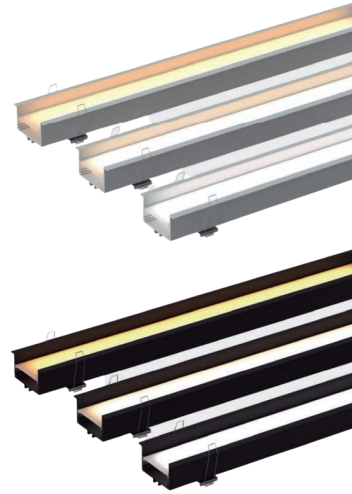

- 2700k | FL1767 ○
- 4000k | FL1768 ○
- 6000k | FL1769 ○
- 2700k | FL1776 ●
- 4000k | FL1777 ●
- 6000k | FL1778 ●

2 metros

Potência: 30w  
 Grau de proteção: IP20  
 Perfil: Branco/ Preto  
 Difusor: Leitoso  
 Dimensões: 2000x50x34mm

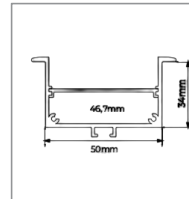

## PERFIL RECUADO

45W

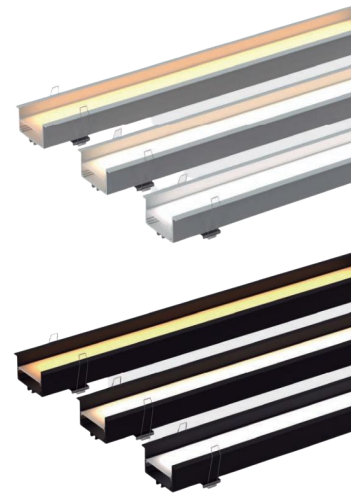

- 2700k | FL1770 ○
- 4000k | FL1771 ○
- 6000k | FL1772 ○
- 2700k | FL1779 ●
- 4000k | FL1780 ●
- 6000k | FL1781 ●

3 metros

Potência: 45w  
 Grau de proteção: IP20  
 Perfil: Branco/ Preto  
 Difusor: Leitoso  
 Dimensões: 3000x50x34mm

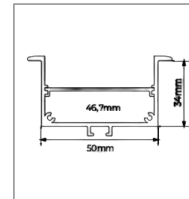

## PERFIL RECUADO

15W



- 2700k | FL1782 ○
- 4000k | FL1783 ○
- 6000k | FL1784 ○

1 metro

Potência: 15w  
 Grau de proteção: IP20  
 Perfil: Preto  
 Difusor: Fumê  
 Dimensões: 1000x50x34mm

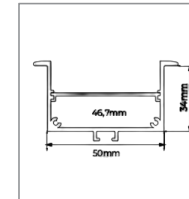

## PERFIL RECUADO

30W



- 2700k | FL1785 ○
- 4000k | FL1786 ○
- 6000k | FL1787 ○

2 metros

Potência: 30w  
 Grau de proteção: IP20  
 Perfil: Preto  
 Difusor: Fumê  
 Dimensões: 2000x50x34mm

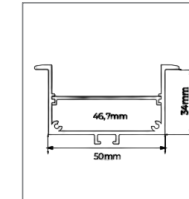

## PERFIL RECUADO

45W



- 2700k | FL1788 ○
- 4000k | FL1789 ○
- 6000k | FL1790 ○

3 metros

Potência: 45w  
 Grau de proteção: IP20  
 Perfil: Preto  
 Difusor: Fumê  
 Dimensões: 3000x50x34mm

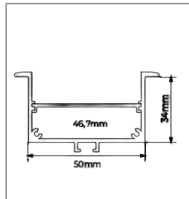

# PERFIS EMBUTIR RECUADO LED INTEGRADO



## CONECTOR PAREDE

3W



- 2700k | FL1791 ○
- 4000k | FL1792 ○
- 6000k | FL1793 ○
- 2700k | FL1794 ●
- 4000k | FL1795 ●
- 6000k | FL1796 ●

Potência: 3w  
 Grau de proteção: IP20  
 Perfil: Branco/ Preto  
 Difusor: Leitoso

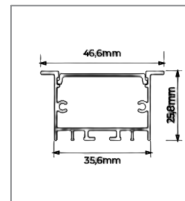

## CONECTOR TETO

3W



- 2700k | FL1822 ○
- 4000k | FL1847 ○
- 6000k | FL1848 ○
- 2700k | FL1849 ●
- 4000k | FL1850 ●
- 6000k | FL1851 ●

Potência: 3w  
 Grau de proteção: IP20  
 Perfil: Branco/ Preto  
 Difusor: Leitoso

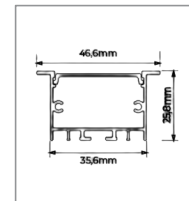

## CONECTOR POSITIVO

3W



- 2700k | FL1800 ○
- 4000k | FL1813 ○
- 6000k | FL1814 ○
- 2700k | FL1815 ●
- 4000k | FL1816 ●
- 6000k | FL1817 ●

Potência: 3w  
 Grau de proteção: IP20  
 Perfil: Branco/ Preto  
 Difusor: Leitoso

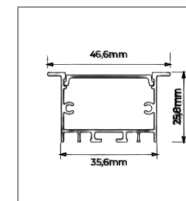

## CONECTOR PAREDE

3W

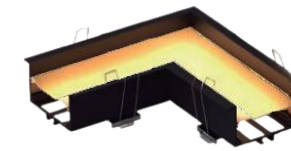

- 2700k | FL1797 ○
- 4000k | FL1798 ○
- 6000k | FL1799 ○

Potência: 3w  
 Grau de proteção: IP20  
 Perfil: Preto  
 Difusor: Fumê

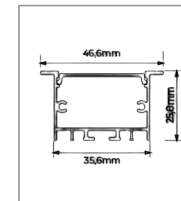

## CONECTOR TETO

3W



- 2700k | FL1852 ○
- 4000k | FL1853 ○
- 6000k | FL1854 ○

Potência: 3w  
 Grau de proteção: IP20  
 Perfil: Preto  
 Difusor: Fumê

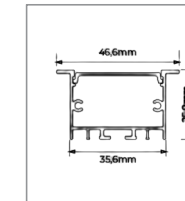

## CONECTOR POSITIVO

3W



- 2700k | FL1818 ○
- 4000k | FL1819 ○
- 6000k | FL1821 ○

Potência: 3w  
 Grau de proteção: IP20  
 Perfil: Preto  
 Difusor: Fumê

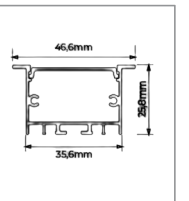



# PERFIS SOBREPOR LED INTEGRADO



## PERFIL FINO

15W

- 2700k | FL1481 ○
- 4000k | FL1482 ○
- 6000k | FL1483 ○
- 2700k | FL1490 ●
- 4000k | FL1491 ●
- 6000k | FL1492 ●



1 metro

- Potência: 15w
- Grau de proteção: IP20
- Perfil: Branco/ Preto
- Difusor: Leitoso
- Dimensões: 1000x17,2x14,4mm

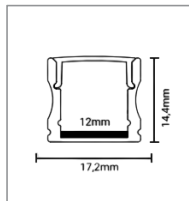

## PERFIL FINO

30W

- 2700k | FL1484 ○
- 4000k | FL1485 ○
- 6000k | FL1486 ○
- 2700k | FL1493 ●
- 4000k | FL1494 ●
- 6000k | FL1495 ●



2 metros

- Potência: 30w
- Grau de proteção: IP20
- Perfil: Branco/ Preto
- Difusor: Leitoso
- Dimensões: 2000x17,2x14,4mm

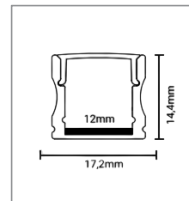

## PERFIL FINO

45W

- 2700k | FL1487 ○
- 4000k | FL1488 ○
- 6000k | FL1489 ○
- 2700k | FL1496 ●
- 4000k | FL1497 ●
- 6000k | FL1498 ●



3 metros

- Potência: 45w
- Grau de proteção: IP20
- Perfil: Branco/ Preto
- Difusor: Leitoso
- Dimensões: 3000x17,2x14,4mm

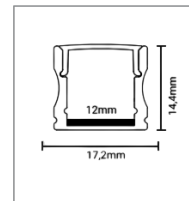

## PERFIL FINO

15W

- 2700k | FL1499 ○
- 4000k | FL1500 ○
- 6000k | FL1501 ○

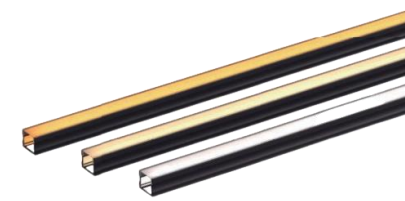

1 metro

- Potência: 15w
- Grau de proteção: IP20
- Perfil: Preto
- Difusor: Fumê
- Dimensões: 1000x17,2x14,4mm

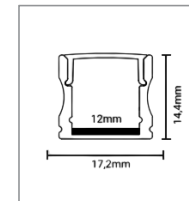

## PERFIL FINO

30W

- 2700k | FL1502 ○
- 4000k | FL1503 ○
- 6000k | FL1504 ○



2 metros

- Potência: 30w
- Grau de proteção: IP20
- Perfil: Preto
- Difusor: Fumê
- Dimensões: 2000x17,2x14,4mm

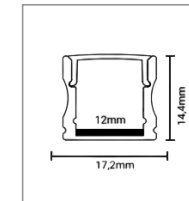

## PERFIL FINO

45W

- 2700k | FL1505 ○
- 4000k | FL1506 ○
- 6000k | FL1507 ○



3 metros

- Potência: 45w
- Grau de proteção: IP20
- Perfil: Preto
- Difusor: Fumê
- Dimensões: 3000x17,2x14,4mm

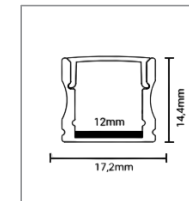

# PERFIS SOBREPOR LED INTEGRADO



## CONECTOR PAREDE

3W

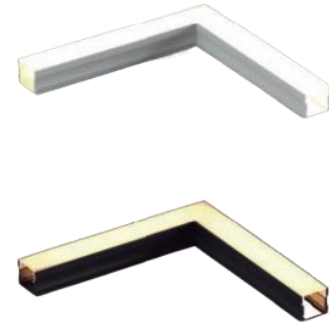

- 2700k | FL1508 ○
- 4000k | FL1509 ○
- 6000k | FL1510 ○
- 2700k | FL1511 ●
- 4000k | FL1512 ●
- 6000k | FL1513 ●

Potência: 3w  
 Grau de proteção: IP20  
 Perfil: Branco/ Preto  
 Difusor: Leitoso

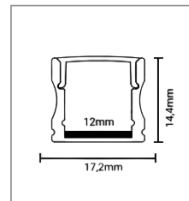

## CONECTOR TETO

3W



- 2700k | FL1526 ○
- 4000k | FL1527 ○
- 6000k | FL1531 ○
- 2700k | FL1532 ●
- 4000k | FL1533 ●
- 6000k | FL1534 ●

Potência: 3w  
 Grau de proteção: IP20  
 Perfil: Branco/ Preto  
 Difusor: Leitoso

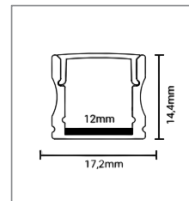

## CONECTOR POSITIVO

3W



- 2700k | FL1517 ○
- 4000k | FL1518 ○
- 6000k | FL1519 ○
- 2700k | FL1520 ●
- 4000k | FL1521 ●
- 6000k | FL1522 ●

Potência: 3w  
 Grau de proteção: IP20  
 Perfil: Branco/ Preto  
 Difusor: Leitoso

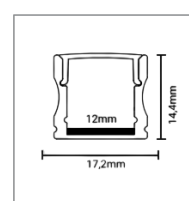

## CONECTOR PAREDE

3W

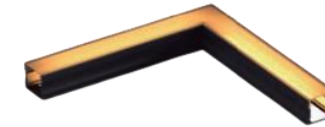

- 2700k | FL1514
- 4000k | FL1515
- 6000k | FL1516

Potência: 3w  
 Grau de proteção: IP20  
 Perfil: Preto  
 Difusor: Fumê

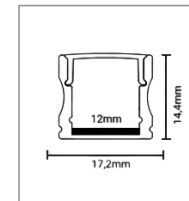

## CONECTOR TETO

3W



- 2700k | FL1535
- 4000k | FL1536
- 6000k | FL1537

Potência: 3w  
 Grau de proteção: IP20  
 Perfil: Preto  
 Difusor: Fumê

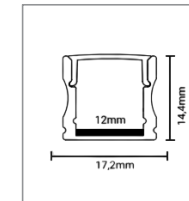

## CONECTOR POSITIVO

3W



- 2700k | FL1523
- 4000k | FL1524
- 6000k | FL1525

Potência: 3w  
 Grau de proteção: IP20  
 Perfil: Preto  
 Difusor: Fumê

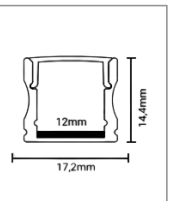

# PERFIS SOBREPOR LED INTEGRADO



## PERFIL MÉDIO

15W

- 2700k | FL1538 ○
- 4000k | FL1539 ○
- 6000k | FL1540 ○
- 2700k | FL1547 ●
- 4000k | FL1548 ●
- 6000k | FL1549 ●

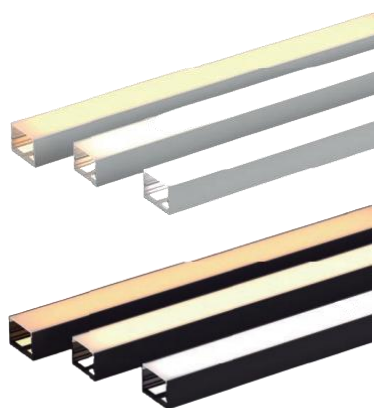

1 metro

Potência: 15w  
 Grau de proteção: IP20  
 Perfil: Branco/ Preto  
 Difusor: Leitoso  
 Dimensões: 1000x35x25mm

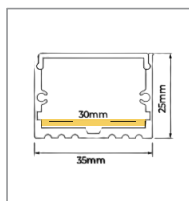

## PERFIL MÉDIO

30W

- 2700k | FL1541 ○
- 4000k | FL1542 ○
- 6000k | FL1543 ○
- 2700k | FL1550 ●
- 4000k | FL1551 ●
- 6000k | FL1552 ●

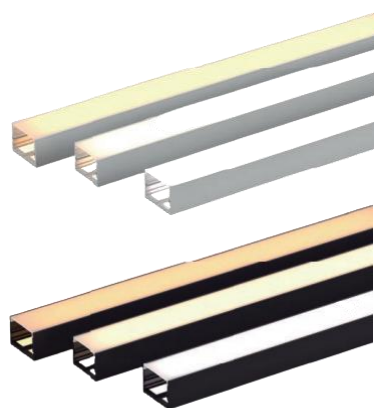

2 metros

Potência: 30w  
 Grau de proteção: IP20  
 Perfil: Branco/ Preto  
 Difusor: Leitoso  
 Dimensões: 2000x35x25mm

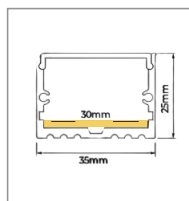

## PERFIL MÉDIO

45W

- 2700k | FL1544 ○
- 4000k | FL1545 ○
- 6000k | FL1546 ○
- 2700k | FL1553 ●
- 4000k | FL1554 ●
- 6000k | FL1555 ●

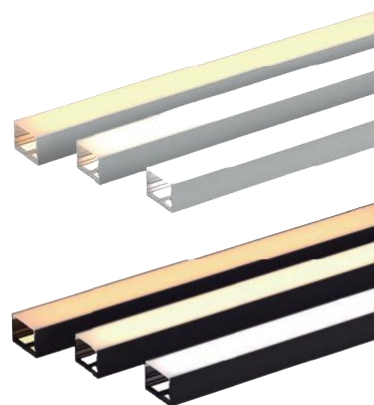

3 metros

Potência: 45w  
 Grau de proteção: IP20  
 Perfil: Branco/ Preto  
 Difusor: Leitoso  
 Dimensões: 3000x35x25mm

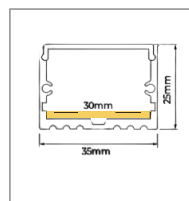

## PERFIL MÉDIO

15W

- 2700k | FL1556 ○
- 4000k | FL1557 ○
- 6000k | FL1558 ○

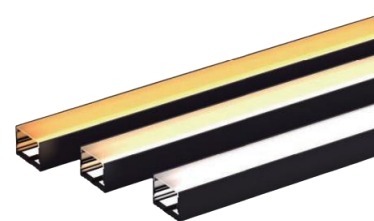

1 metro

Potência: 15w  
 Grau de proteção: IP20  
 Perfil: Preto  
 Difusor: Fumê  
 Dimensões: 1000x35x25mm

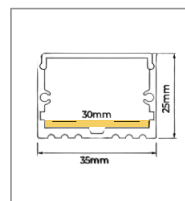

## PERFIL MÉDIO

30W

- 2700k | FL1559 ○
- 4000k | FL1560 ○
- 6000k | FL1561 ○

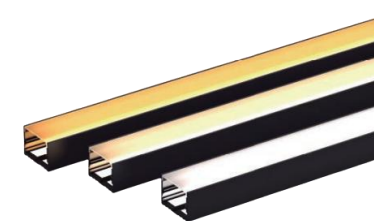

2 metros

Potência: 30w  
 Grau de proteção: IP20  
 Perfil: Preto  
 Difusor: Fumê  
 Dimensões: 2000x35x25mm

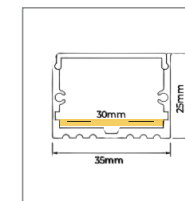

## PERFIL MÉDIO

45W

- 2700k | FL1562 ○
- 4000k | FL1563 ○
- 6000k | FL1564 ○

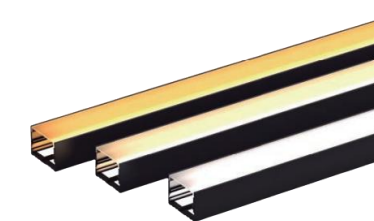

3 metros

Potência: 45w  
 Grau de proteção: IP20  
 Perfil: Preto  
 Difusor: Fumê  
 Dimensões: 3000x35x25mm

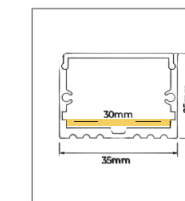



# PERFIS SOBREPOR LED INTEGRADO



## CONECTOR PAREDE

3W

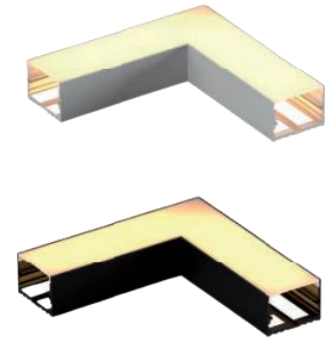

- 2700k | FL1565 ○
- 4000k | FL1566 ○
- 6000k | FL1567 ○
- 2700k | FL1586 ●
- 4000k | FL1587 ●
- 6000k | FL1588 ●

Potência: 3w  
 Grau de proteção: IP20  
 Perfil: Branco/ Preto  
 Difusor: Leitoso

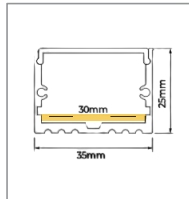

## CONECTOR TETO

3W



- 2700k | FL1583 ○
- 4000k | FL1584 ○
- 6000k | FL1585 ○
- 2700k | FL1586 ●
- 4000k | FL1587 ●
- 6000k | FL1588 ●

Potência: 3w  
 Grau de proteção: IP20  
 Perfil: Branco/ Preto  
 Difusor: Leitoso

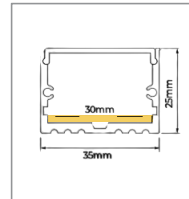

## CONECTOR POSITIVO

3W



- 2700k | FL1574 ○
- 4000k | FL1575 ○
- 6000k | FL1576 ○
- 2700k | FL1577 ●
- 4000k | FL1578 ●
- 6000k | FL1579 ●

Potência: 3w  
 Grau de proteção: IP20  
 Perfil: Branco/ Preto  
 Difusor: Leitoso

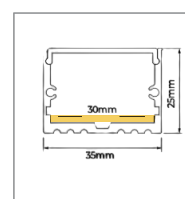

## CONECTOR PAREDE

3W

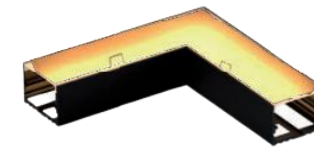

- 2700k | FL1571 ○
- 4000k | FL1572 ○
- 6000k | FL1573 ○

Potência: 3w  
 Grau de proteção: IP20  
 Perfil: Preto  
 Difusor: Fumê

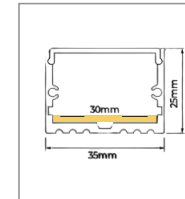

## CONECTOR TETO

3W



- 2700k | FL1589 ○
- 4000k | FL1590 ○
- 6000k | FL1591 ○

Potência: 3w  
 Grau de proteção: IP20  
 Perfil: Preto  
 Difusor: Fumê

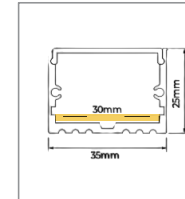

## CONECTOR POSITIVO

3W



- 2700k | FL1580 ○
- 4000k | FL1581 ○
- 6000k | FL1582 ○

Potência: 3w  
 Grau de proteção: IP20  
 Perfil: Preto  
 Difusor: Fumê

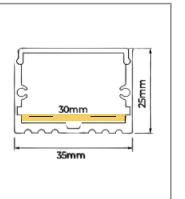



# PERFIS NOFRAME EMBUTIR LED INTEGRADO

## NOFRAME UNILATERAL

15W

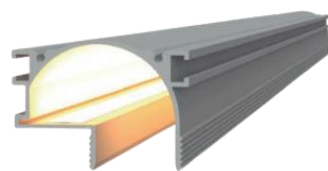

- 2700k | FL1873 ○
- 4000k | FL1874 ○
- 6000k | FL1875 ○

## NOFRAME UNILATERAL

30W

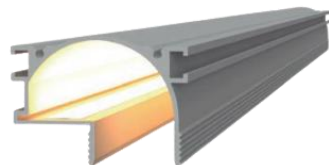

- 2700k | FL1876 ○
- 4000k | FL1877 ○
- 6000k | FL1878 ○

## NOFRAME UNILATERAL

45W

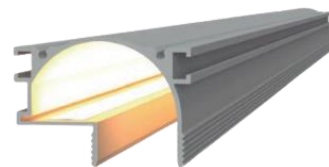

- 2700k | FL1879 ○
- 4000k | FL1880 ○
- 6000k | FL1881 ○

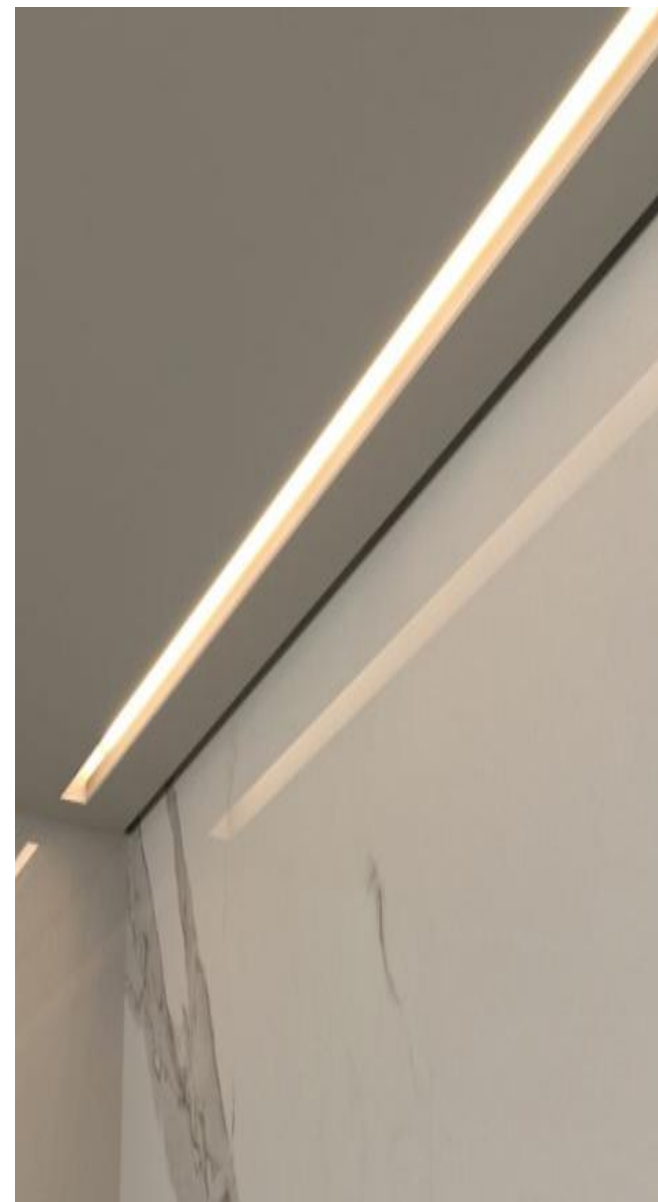

## CONECTOR UNILATERAL

3W



- 2700k | FL1882
- 4000k | FL1883
- 6000k | FL1884

## CONECTOR UNILATERAL

3W

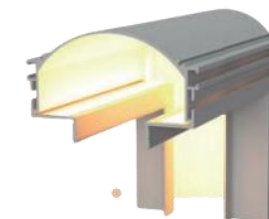

- 2700k | FL1894
- 4000k | FL1895
- 6000k | FL1896

### 1 metro

Potência: 15w  
 Grau de proteção: IP20  
 Perfil: Branco  
 Dimensões: 1000x54,8x39,7mm

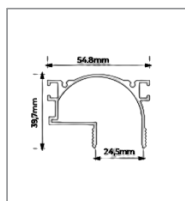

### 2 metros

Potência: 30w  
 Grau de proteção: IP20  
 Perfil: Branco  
 Dimensões: 1000x54,8x39,7mm

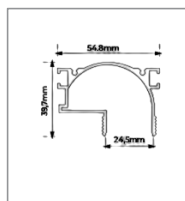

### 3 metros

Potência: 45w  
 Grau de proteção: IP20  
 Perfil: Branco  
 Dimensões: 1000x54,8x39,7mm

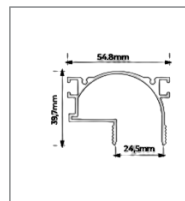

Potência: 3w  
 Grau de proteção: IP20  
 Perfil: Branco

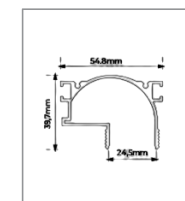

Potência: 3w  
 Grau de proteção: IP20  
 Perfil: Branco

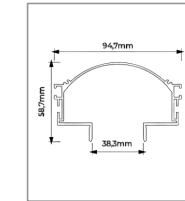

# PERFIS NOFRAME EMBUTIR LED INTEGRADO



## NOFRAME UNILATERAL

15W

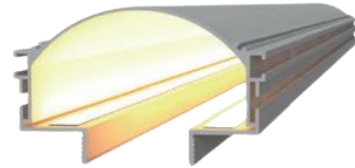

- 2700k | FL1885 ○
- 4000k | FL1886 ○
- 6000k | FL1887 ○

1 metro

- Potência: 15w
- Grau de proteção: IP20
- Perfil: Branco
- Dimensões: 1000x94,7x58,7mm

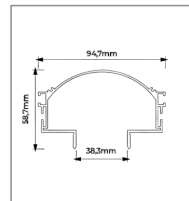

## NOFRAME UNILATERAL

30W

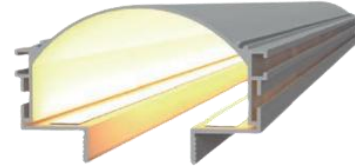

- 2700k | FL1888 ○
- 4000k | FL1889 ○
- 6000k | FL1890 ○

2 metros

- Potência: 30w
- Grau de proteção: IP20
- Perfil: Branco
- Dimensões: 1000x94,7x58,7mm

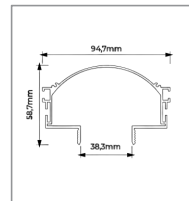

## NOFRAME UNILATERAL

45W

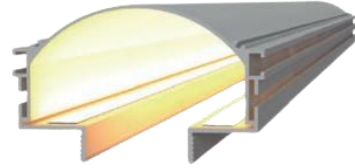

- 2700k | FL1891 ○
- 4000k | FL1892 ○
- 6000k | FL1893 ○

3 metros

- Potência: 45w
- Grau de proteção: IP20
- Perfil: Branco
- Dimensões: 1000x94,7x58,7mm

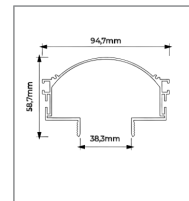

# PERFIL RIPADO

## PERFIL RIPADO

- 1 metro | FL1987
- 2 metros | FL1988
- 3 metros | FL1989



- Filtro até 6,7mm
- Tampas de fechamento
- IP20

- Corte: Reto
- Grau de proteção: IP20
- Perfil: Branco
- Difusor: Leitoso
- Material: PMMA e alumínio
- Dimensões: 1000x9,9x9,9mm

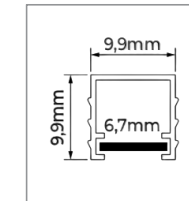





## CANTONEIRA

15W

2700k | FL1646

4000k | FL1647

6000k | FL1648



## CANTONEIRA

30W

2700k | FL1649

4000k | FL1650

6000k | FL1651

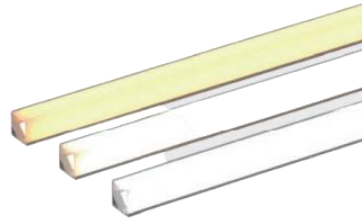

## CANTONEIRA

45W

2700k | FL1652

4000k | FL1653

6000k | FL1654

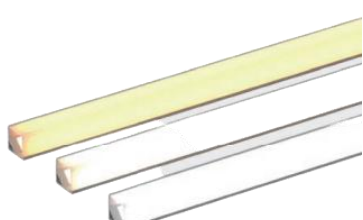

## PERFIL RETO

15W

2700k | FL1855

4000k | FL1856

6000k | FL1857

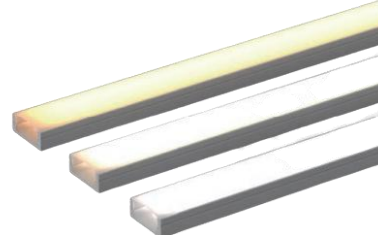

## PERFIL RETO

30W

2700k | FL1858

4000k | FL1859

6000k | FL1860

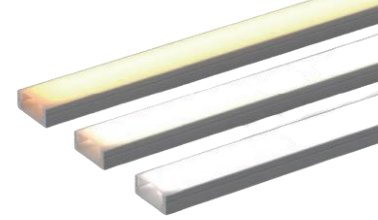

## PERFIL RETO

45W

2700k | FL1861

4000k | FL1862

6000k | FL1863

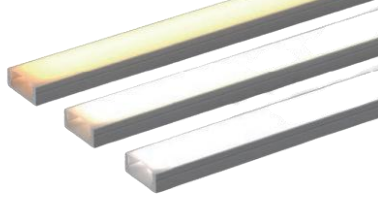

1 metro

Potência: 15w  
Grau de proteção: IP20  
Perfil: Branco  
Difusor: Leitoso  
Dimensões: 1000x16x16mm

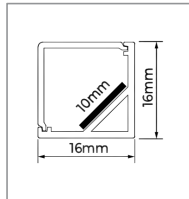

2 metros

Potência: 30w  
Grau de proteção: IP20  
Perfil: Branco  
Difusor: Leitoso  
Dimensões: 1000x16x16mm

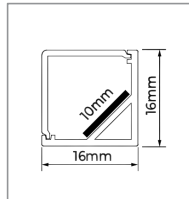

3 metros

Potência: 45w  
Grau de proteção: IP20  
Perfil: Branco  
Difusor: Leitoso  
Dimensões: 1000x16x16mm

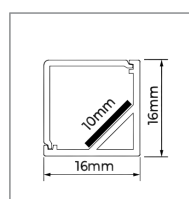

Potência: 15w  
Grau de proteção: IP20  
Perfil: Branco  
Difusor: Leitoso  
Dimensões: 1000x17,5x7mm

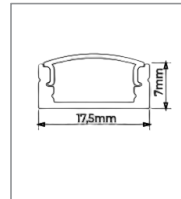

Potência: 30w  
Grau de proteção: IP20  
Perfil: Branco  
Difusor: Leitoso  
Dimensões: 1000x17,5x7mm

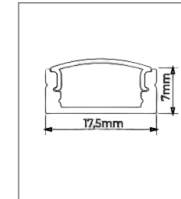

Potência: 45w  
Grau de proteção: IP20  
Perfil: Branco  
Difusor: Leitoso  
Dimensões: 1000x17,5x7mm

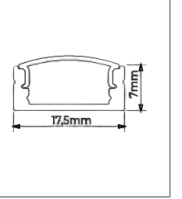



## BRANCO LEITOSO

Sem aba

- 1 metro | FL1353
- 2 metros | FL1354
- 3 metros | FL1355



Com aba

- 1 metro | FL1957
- 2 metros | FL1958
- 3 metros | FL1959



Grau de proteção: IP20  
 Perfil: Branco  
 Difusor: Leitoso

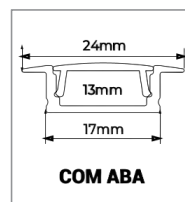
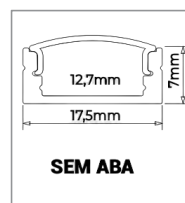

## PRETO LEITOSO

Sem aba

- 1 metro | FL1951
- 2 metros | FL1952
- 3 metros | FL1953



Com aba

- 1 metro | FL1960
- 2 metros | FL1961
- 3 metros | FL1962



Grau de proteção: IP20  
 Perfil: Preto  
 Difusor: Leitoso

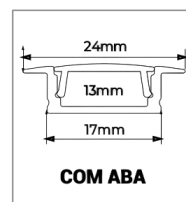
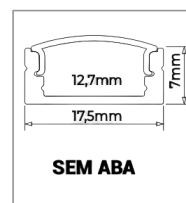

## PRETO FUMÊ

Sem aba

- 1 metro | FL1954
- 2 metros | FL1955
- 3 metros | FL1956



Com aba

- 1 metro | FL1963
- 2 metros | FL1964
- 3 metros | FL1965



Grau de proteção: IP20  
 Perfil: Preto  
 Difusor: Fumê

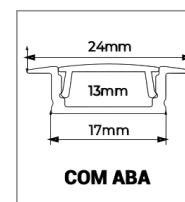
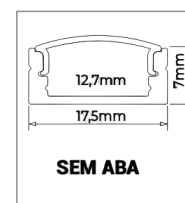

## BRANCO LEITOSO

- 1 metro | FL1972
- 2 metros | FL1973
- 3 metros | FL1974



Grau de proteção: IP20  
 Perfil: Branco  
 Difusor: Leitoso  
 Material: PMMA e alumínio  
 Dimensões: 1000x37x42mm

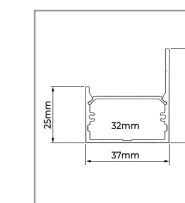

# PERFIL SANCA RODATETO



## PRETO LEITOSO

- 1 metro | FL1975
- 2 metros | FL1976
- 3 metros | FL1977



## PRETO FUMÊ

- 1 metro | FL1978
- 2 metros | FL1979
- 3 metros | FL1980



## PERFIL BRANCO

10w/m  
2700k

- 1 metro | FL1981
- 2 metros | FL1982
- 3 metros | FL1983

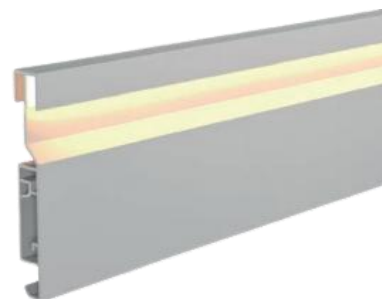

## PERFIL PRETO

10w/m  
2700k

- 1 metro | FL1984
- 2 metros | FL1985
- 3 metros | FL1986

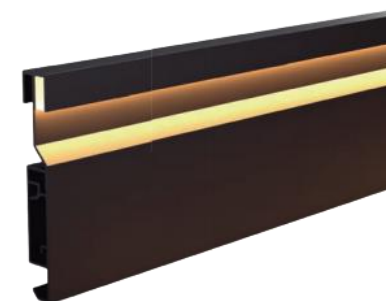

- Corte: Reto/ 45° TT
- Grau de proteção: IP65
- Perfil: Branco
- Fixação: Suporte de Alumínio
- Material: Alumínio Extrudado
- Instalação: Gesso/Madeira/Alv.
- Dimensões: 1000x15x100mm

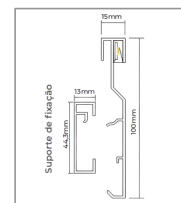

- Corte: Reto/ 45° TT
- Grau de proteção: IP65
- Perfil: Preto
- Fixação: Suporte de Alumínio
- Material: Alumínio Extrudado
- Instalação: Gesso/Madeira/Alv.
- Dimensões: 1000x15x100mm

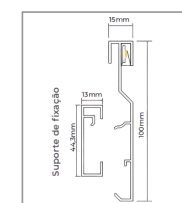

- Grau de proteção: IP20
- Perfil: Preto
- Difusor: Leitoso
- Material: PMMA e alumínio
- Dimensões: 1000x37x42mm

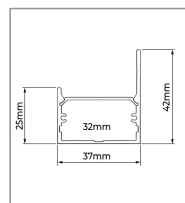

- Grau de proteção: IP20
- Perfil: Preto
- Difusor: Fumê
- Material: PMMA e alumínio
- Dimensões: 1000x37x42mm

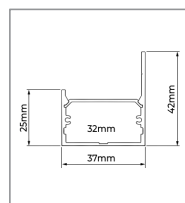



# PERFIS SOBREPOR



## PERFIL FINO

- 1 metro | FL.974
- 2 metros | FL.975
- 3 metros | FL.1109
- Parede | FL.977
- Teto | FL.976
- Positivo | FL.1124

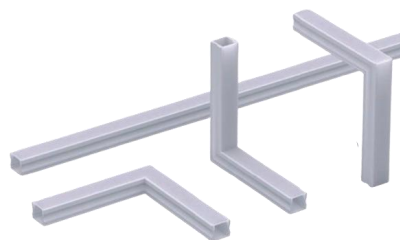

Grau de proteção: IP20  
 Perfil: Branco  
 Difusor: Leitoso  
 Dimensões: 1000x17,2x14,4mm

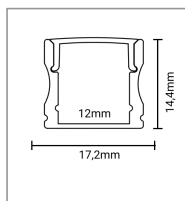

## PERFIL FINO

- 1 metro | FL.1266
- 2 metros | FL.1268
- 3 metros | FL.1312
- Parede | FL.1272
- Teto | FL.1270
- Positivo | FL.1324

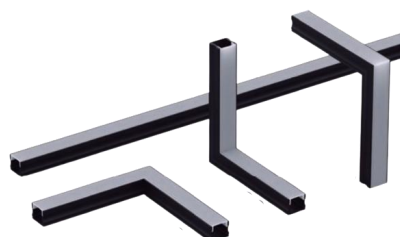

Grau de proteção: IP20  
 Perfil: Preto  
 Difusor: Leitoso  
 Dimensões: 1000x17,2x14,4mm

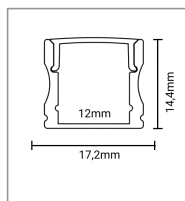

## PERFIL FINO

- 1 metro | FL.1265
- 2 metros | FL.1267
- 3 metros | FL.1311
- Parede | FL.1271
- Teto | FL.1269
- Positivo | FL.1323

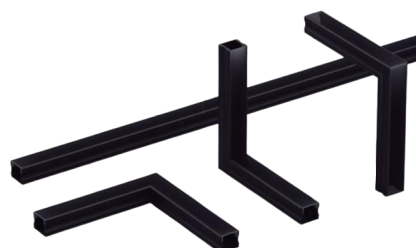

Grau de proteção: IP20  
 Perfil: Preto  
 Difusor: Fumê  
 Dimensões: 1000x17,2x14,14mm

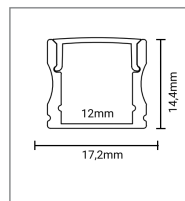

## KIT PENDENTE

- Cabo 150cm | FL.1388
- Cabo 300cm | FL.1389



Potência: 30w  
 Grau de proteção: IP20  
 Perfil: Branco  
 Difusor: Leitoso  
 Dimensões: 1000x17,5x7mm

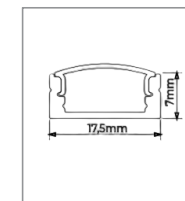





## PERFIL MÉDIO

- 1 metro | FL.978
- 2 metros | FL.979
- 3 metros | FL.1110
- Parede | FL.981
- Teto | FL.980
- Positivo | FL.1100

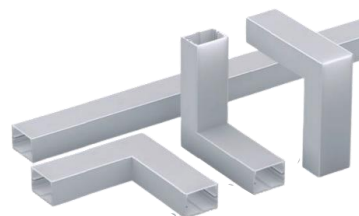

## PERFIL MÉDIO

- 1 metro | FL.1274
- 2 metros | FL.1276
- 3 metros | FL.1314
- Parede | FL.1280
- Teto | FL.1326
- Positivo | FL.1278

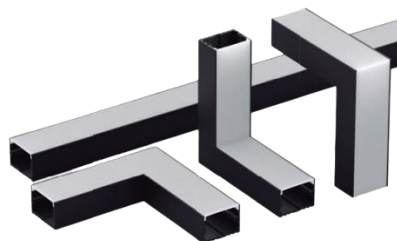

## PERFIL MÉDIO

- 1 metro | FL.1273
- 2 metros | FL.1275
- 3 metros | FL.1313
- Parede | FL.1279
- Teto | FL.1277
- Positivo | FL.1325

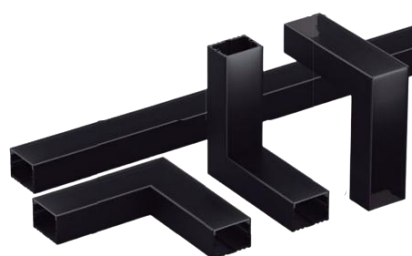

## PERFIL LARGO

- 1 metro | FL.1379
- 2 metros | FL.1380
- 3 metros | FL.1381
- Parede | FL.1835
- Teto | FL.1834
- Positivo | FL.1836

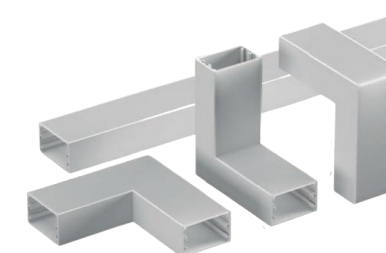

## PERFIL LARGO

- 1 metro | FL.1382
- 2 metros | FL.1383
- 3 metros | FL.1384
- Parede | FL.1838
- Teto | FL.1837
- Positivo | FL.1839

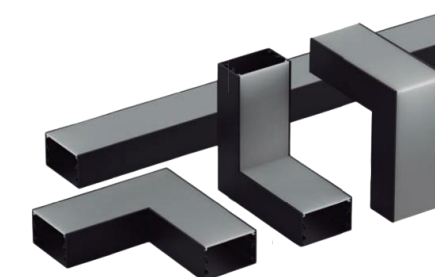

Grau de proteção: IP20  
 Perfil: Branco  
 Difusor: Leitoso  
 Dimensões: 1000x35x25mm

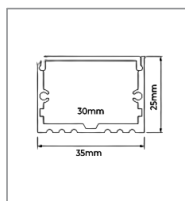

Grau de proteção: IP20  
 Perfil: Preto  
 Difusor: Leitoso  
 Dimensões: 1000x35x25mm

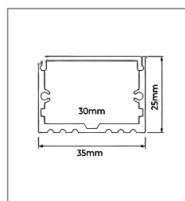

Grau de proteção: IP20  
 Perfil: Preto  
 Difusor: Fumê  
 Dimensões: 1000x35x25mm

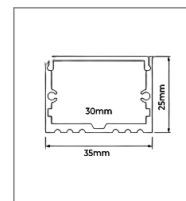

Grau de proteção: IP20  
 Perfil: Branco  
 Difusor: Leitoso  
 Dimensões: 1000x50x30mm

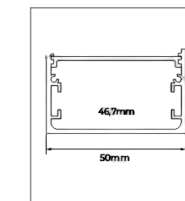

Grau de proteção: IP20  
 Perfil: Preto  
 Difusor: Leitoso  
 Dimensões: 1000x50x30mm

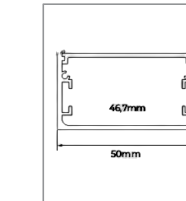



## PERFIL LARGO

- 1 metro | FL1385
- 2 metros | FL1386
- 3 metros | FL1387
- Parede | FL1841
- Teto | FL1840
- Positivo | FL1842

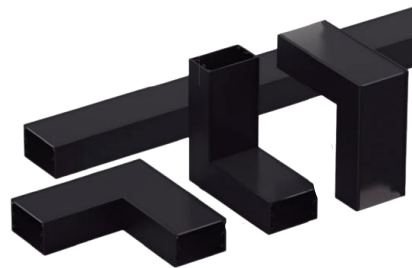

Grau de proteção: IP20  
 Perfil: Preto  
 Difusor: Fumê  
 Dimensões: 1000x50x30mm

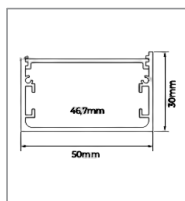

## PERFIL MÉDIO

- 1 metro | FL1914
- 2 metros | FL1915
- 3 metros | FL1916
- Parede | FL1924
- Teto | FL1923
- Positivo | FL1925

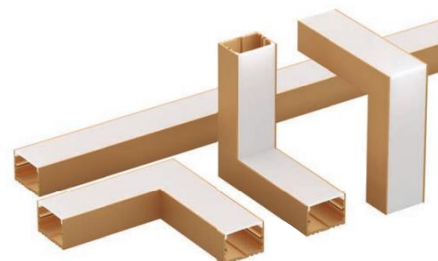

Grau de proteção: IP20  
 Perfil: Outro Champagne  
 Difusor: Leitoso  
 Dimensões: 1000x35x25mm

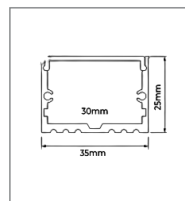

## PERFIL MÉDIO

- 1 metro | FL1917
- 2 metros | FL1918
- 3 metros | FL1919
- Parede | FL1927
- Teto | FL1926
- Positivo | FL1928

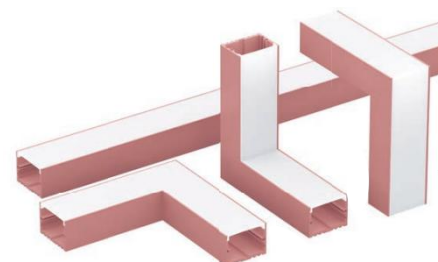

Grau de proteção: IP20  
 Perfil: Rosê  
 Difusor: Leitoso  
 Dimensões: 1000x35x25mm

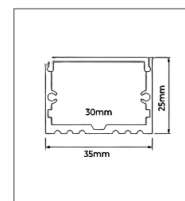

## PERFIL MÉDIO

- 1 metro | FL1920
- 2 metros | FL1921
- 3 metros | FL1922
- Parede | FL1930
- Teto | FL1929
- Positivo | FL1931

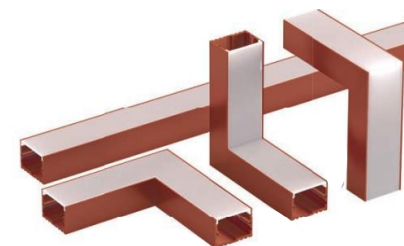

Grau de proteção: IP20  
 Perfil: Cobre Envelhecido  
 Difusor: Leitoso  
 Dimensões: 1000x35x25mm

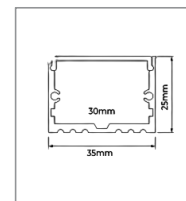

# LINHA COLORS SOBREPOR



## PERFIL LARGO

- 1 metro | FL1932
- 2 metros | FL1933
- 3 metros | FL1934
- Parede | FL1942
- Teto | FL1941
- Positivo | FL1943

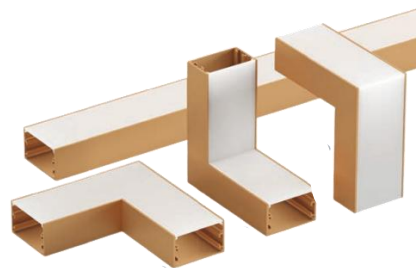

## PERFIL LARGO

- 1 metro | FL1935
- 2 metros | FL1936
- 3 metros | FL1937
- Parede | FL1945
- Teto | FL1944
- Positivo | FL1946

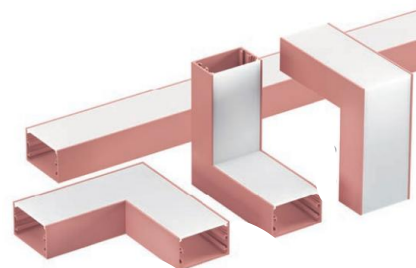

## PERFIL LARGO

- 1 metro | FL1938
- 2 metros | FL1939
- 3 metros | FL1940
- Parede | FL1948
- Teto | FL1947
- Positivo | FL1949

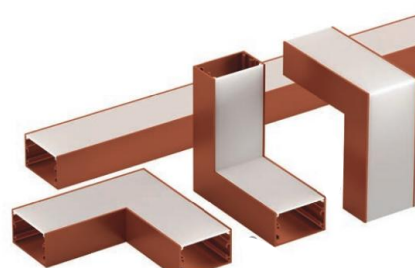

Grau de proteção: IP20  
 Perfil: Outro Champagne  
 Difusor: Leitoso  
 Dimensões: 1000x50x30mm

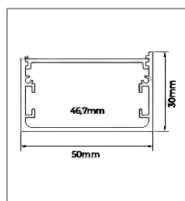

Grau de proteção: IP20  
 Perfil: Rosê  
 Difusor: Leitoso  
 Dimensões: 1000x35x25mm

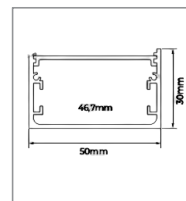

Grau de proteção: IP20  
 Perfil: Cobre Envelhecido  
 Difusor: Leitoso  
 Dimensões: 1000x35x25mm

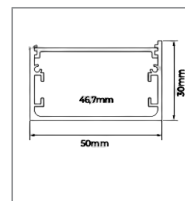

# SISTEMA MODULAR SOBREPOR

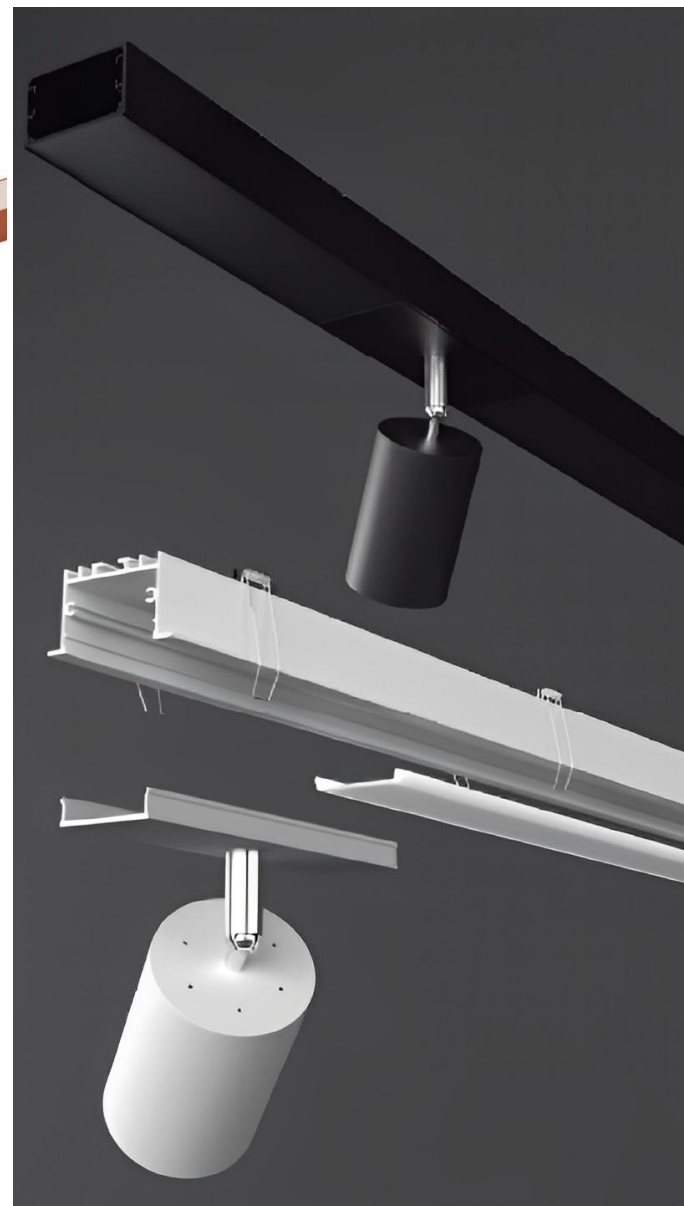

## TAMPA CEGA PARA PERFIS SOBREPOR/EMBTUTIR

- BR 50cm | FL2054
- BR 1m | FL2055
- BR 2m | FL2056
- PT 50cm | FL2057
- PT 1m | FL2058
- PT 2m | FL2059



30mm

- BR 50cm | FL2060
- BR 1m | FL2061
- BR 2m | FL2062
- PT 50cm | FL2063
- PT 1m | FL2064
- PT 2m | FL2065



50mm

## MÓDULO SPOT PARA PERFIS SOBREPOR/EMBTUTIR



30mm

- PT GU10 | FL2066
- BR GU10 | FL2067
- BR/DO GU10 | FL2199
- PT/DO GU10 | FL2200
- BR/CO GU10 | FL2201
- PT/CO GU10 | FL2202
- BR/RO GU10 | FL2203
- PT/RO GU10 | FL2204
- PT PAR20 | FL2068
- BR PAR20 | FL2069
- PT AR70 | FL2070
- BR AR70 | FL2071
- BR PAR30 | FL2072
- PT PAR30 | FL2073
- BR AR111 | FL2074
- PT AR111 | FL2075

50mm

- PT GU10 | FL2076
- BR GU10 | FL2077
- BR/DO GU10 | FL2205
- PT/DO GU10 | FL2206
- BR/CO GU10 | FL2207
- PT/CO GU10 | FL2208
- BR/RO GU10 | FL2209
- PT/RO GU10 | FL2210
- PT PAR20 | FL2078
- BR PAR20 | FL2079
- PT AR70 | FL2080
- BR AR70 | FL2081
- BR PAR30 | FL2082
- PT PAR30 | FL2083
- BR AR111 | FL2084
- PT AR111 | FL2085

Lâmpada não inclusa  
 Potência máxima suportada: Dicroica 8W - PAR20 8W - AR70 8W - PAR30 8W - AR111 até 15W

# TABELA DRIVERS 12V



Potência do Driver	24w	36w	48w	60w	72w	100w	150w	200w	250w	300w	400w
Whatts/metro	Metros que é possível ligar com a fita/driver										
5	3,8m	5,8m	7,7m	9,6m	11,5m	16m	24m	32m	40m	48m	64m
10	1,9m	2,9m	3,8m	4,8m	5,8m	8m	12m	16m	20m	24m	32m
12	1,7m	2,6m	3,5m	4,4m	5,2m	7,3m	10,9m	14,5m	18,2m	21,8m	29,1m
15	1,3m	1,9m	2,6m	3,2m	3,8m	5,3m	8m	10,7m	13,3m	16m	21,3m
19	1m	1,4m	1,9m	2,4m	2,9m	4m	6m	8m	10m	12m	16m



